

ALSO AVAILABLE

QUARTERING TOOL

Create features based on quartering descriptions

ONLINE DATA SERVICE

TractBuilderLive provides online access to section and parcel data. No more time wasted searching for data.

MAPPING SERVICES

TractBuilder provides a full array of mapping services from drafting and project management to custom tool creation.

Metes & Bounds Tool

Make working with metes & bounds legal descriptions easier with TractBuilder's Metes & Bounds Tool. With the tool you can create polygons from legal descriptions or convert a polygon into metes & bounds calls.

Summary of Features

- Easy to use
- Supports direction/bearing, curve, and XY call types
- Use Guided call entry or Shorthand entry
- AutoTranslate¹ converts long form legal descriptions into polygons
- Prevent errors by quickly seeing the resulting acreage and closure error

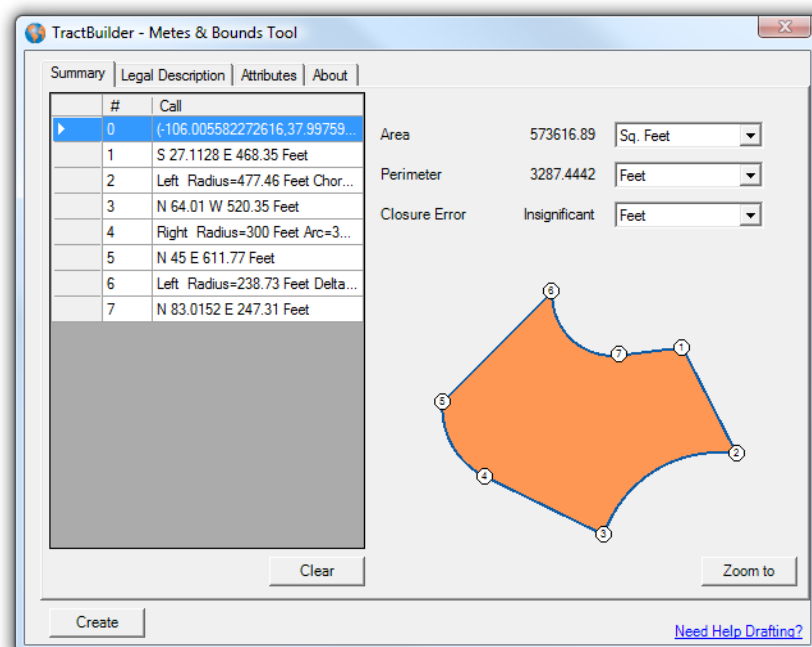

Metes & Bounds Tool

Guided Entry

When entering in a metes & bounds legal description for mapping, some users may be unfamiliar with the required syntax to describe a particular call type. In this situation the user may select the appropriate call type and then enter the prompted values. The tool will show a preview of the shorthand for the call entry and allow the user to add it to the description by pressing the Add button.

The Guided Entry feature is typically used for entering in Curve Call information since there is a variety of forms that a metes & bounds curve call may be described.

The screenshot displays the 'TractBuilder - Metes & Bounds Tool' window. It features a 'Legal Description' tab and a 'Freehand Text' area containing a list of coordinates and bearings. The 'Guided Entry' panel is active, showing a 'Call Type' dropdown set to 'Direction/Bearing'. Below this, there are input fields for 'Direction' (set to 'North'), 'Degrees' (11), 'Minutes' (12), 'Seconds' (13), 'Bearing' (set to 'East'), and 'Distance' (3242) with a unit dropdown set to 'Feet'. A preview of the resulting shorthand 'N 11.1213 E 3242 Feet' is shown next to an 'Add' button. At the bottom, there are 'Shorthand' and 'Full' tabs, a 'Create' button, and a 'Need Help Drafting?' link.

Metes & Bounds Tool

AutoTranslation

Reading through a metes & bounds description and extracting the call information can be a cumbersome and difficult task. AutoTranslation can help process legal descriptions from surveyors and generate features automatically.

How it works

Copy and paste the text legal description into the Metes & Bounds Auto Convert form and press the Convert button.

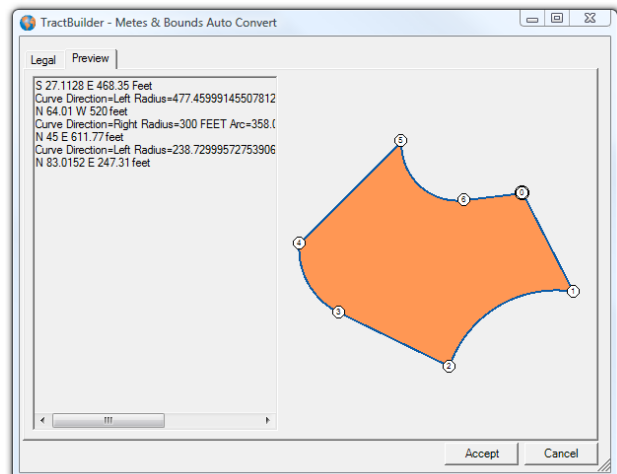
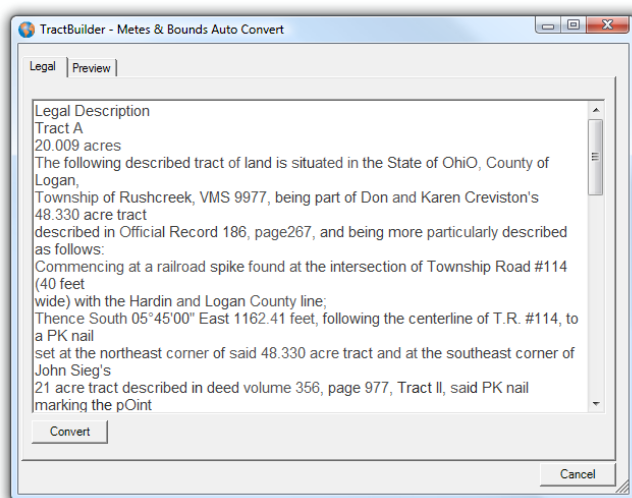

¹ AutoTranslation requires a TractBuilder online account

Metes & Bounds Tool

Converting Polygons to Metes & Bounds

At times it may be required to convert an existing polygon into metes & bounds calls. This task is easily accomplished within seconds using TractBuilder tools.

How it works

Select the polygon and press the Convert Polygon to Metes & Bounds button.

Select the starting point for the conversion (if desired) and the direction.

